



## LED CLIP LAMP

- GB** **LED CLIP LAMP**  
Operation and safety notes
- SK** **UPÍNACIA LED LAMPA**  
Pokyny pre obsluhu a bezpečnostné pokyny

- DE** **AT** **CH**  
**LED-KLEMMLEUCHE**  
Bedienungs- und Sicherheitshinweise

IAN 487938\_2407

SK

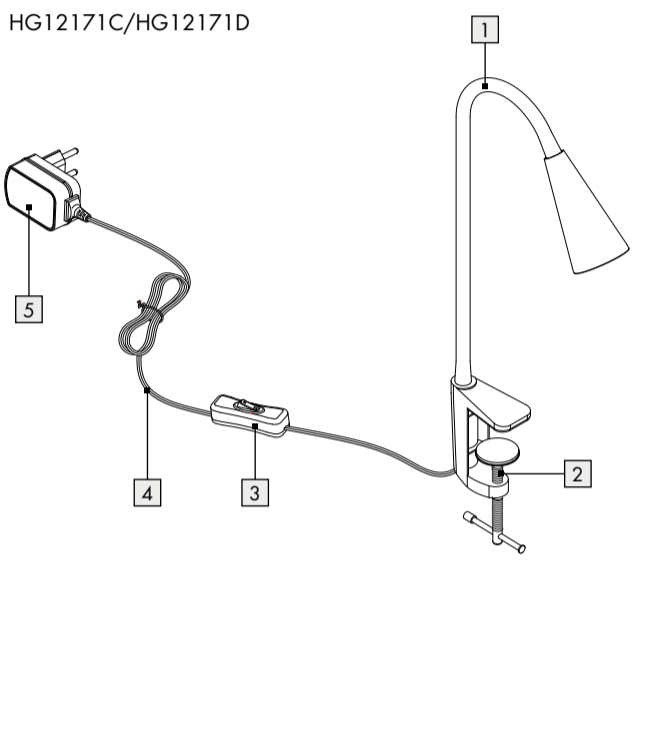
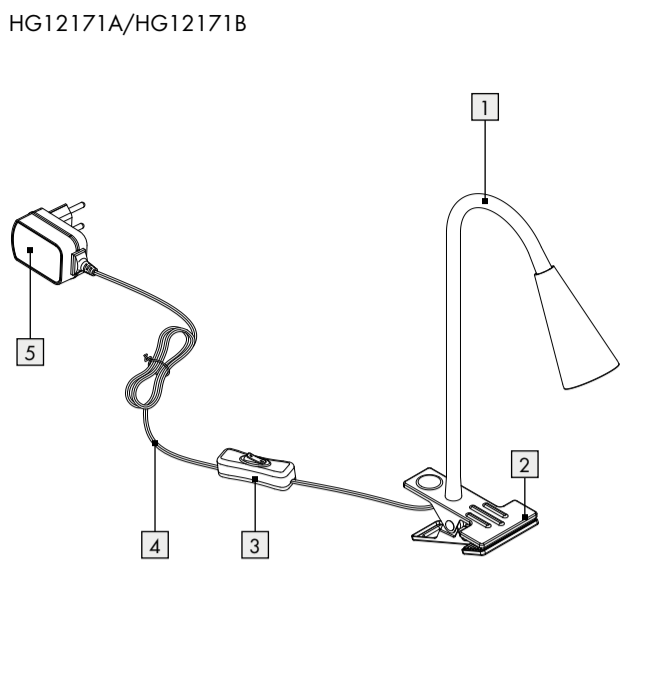

List of pictograms used	
	Short-circuit proof safety transformer
	Separate control unit
	Use indoors
	Alternating current/voltage
	CE mark indicates conformity with relevant EU directives applicable for this product.
	Safety class II
	Direct current/voltage
	Not dimmable
	Distance to illuminated surfaces: at least 0.1 m
	Safety information
	Instructions for use

### LED clip lamp

#### ● Introduction

We congratulate you on the purchase of your new product. You have chosen a high quality product. The instructions for use are part of the product. They contain important information concerning safety, use and disposal. Before using the product, please familiarise yourself with all of the safety information and instructions for use. Only use the product as described and for the specified applications. If you pass the product on to anyone else, please ensure that you also pass on all the documentation with it.

#### ● Intended use

This product is intended for use indoors only, in dry and enclosed rooms. The product is not intended to be used for commercial purposes.

#### ● Description of parts

- |                            |                        |
|----------------------------|------------------------|
| <b>1</b> Flexible lamp arm | <b>4</b> Power cable   |
| <b>2</b> Clamping fixture  | <b>5</b> Mains adapter |
| <b>3</b> ON/OFF switch     |                        |

#### ● Technical data

Total power: 3.5 W  
LED power: 2.7 W

#### LED clip lamp:

LEDs: 6 LED  
The LED cannot be replaced by user.  
This product contains light sources of energy efficiency class F.

#### Mains adapter:

Rated voltage, primary: 200–240V~ 50/60Hz  
Rated voltage, secondary: 9–12V, 0.26 A, 3.12 W  
Protection class: II/

Model No.: HS1200260V

SELV: Safety extra low voltage  
ta: Maximum rated ambient temperature  
tc: Rated maximum operating temperature of the case of a controlgear

#### ● Included items

- 1 LED clip lamp
- 1 Operating instructions

#### ● Safety

### Safety information

READ THESE INSTRUCTIONS BEFORE USING THE PRODUCT! PLEASE KEEP ALL SAFETY INSTRUCTIONS AND INSTRUCTIONS FOR USE FOR FUTURE REFERENCE!

- WARNING! DANGER OF DEATH AND ACCIDENTS FOR TODDLERS AND CHILDREN!** Never leave children unsupervised with the packaging material. The packaging material represents a danger of suffocation. Children frequently underestimate the dangers. Please keep children away from the product at all times.
- This product is not a toy and should not be played by children. Children are not able to understand the dangers that can occur when handling this product.
- This product can be used by children aged from 8 years and above and persons with reduced physical, sensory or mental capabilities or lack of experience and knowledge if they have been given supervision or instruction concerning use of the product in a safe way and understand

GB

GB

GB

- The product is only suited for use with the included mains adapter **5**.
- Please note that the mains adapter **5** continues to draw a small amount of power even if the product is turned off as long as the mains adapter **5** is plugged into a power outlet. To switch the product off completely, unplug the mains adapter **5** from the socket.
- Light source and LED control gear can only be replaced by specialist.

#### ● Bringing into use

**Note:** Remove all packaging materials from the product.

- Never direct the LED light beam on to reflective surfaces or at people or animals. Failure to observe this advice may result in eye injury and/ or loss of sight to people or animals. Even a weak LED light beam can cause eye damage.
- Attach the product in the desired position by means of the clamping fixture **2**.
- CAUTION! RISK OF SHEARING OR CRUSHING INJURY!** A large force is required to attach the product. This could result in a risk of shearing or crushing injury through trapping parts of your body.
- Insert the mains adapter **5** into an ordinary domestic mains outlet socket (200–240V~).
- Use the ON/OFF switch **3** to switch the product on or off.
- Bend the flexible lamp arm **1** to bring the product into the desired position.  
**Note:** Let the product cool down before you touch it. Do not turn the flexible lamp arm **1** completely about itself or the power cable **4** inside the product could be damaged.

#### ● Maintenance and cleaning

**Note:** The product requires no maintenance. The LEDs cannot be replaced by user.

- Do not use any solvents, petrol or similar. This would cause damage to the product.
- Pull the mains adapter **5** out of the mains socket.
- CAUTION! DANGER OF ELECTRIC SHOCK!** For electrical safety reasons do not clean the product with water or other liquids and never immerse it in water.
- Always use a dry fluff-free cloth for cleaning the product.
- Never direct the LED light beam on to reflective surfaces or at people or animals. Failure to observe this advice may result in eye injury and/ or loss of sight to people or animals. Even a weak LED light beam can cause eye damage.

#### ● Disposal

The packaging is made entirely of recyclable materials, which you may dispose of at local recycling facilities.

- Observe the marking of the packaging materials for waste separation, which are marked with abbreviations (a) and numbers (b) with following meaning: 1–7: plastics/20–22: paper and fibreboard/80–98: composite materials.

- Contact your local refuse disposal authority for more details of how to dispose of your worn-out product.

- To help protect the environment, please dispose of the product properly when it has reached the end of its useful life and not in the household waste. Information on collection points and their opening hours can be obtained from your local authority.

#### ● Warranty

The product has been manufactured to strict quality guidelines and meticulously examined before delivery. In the event of material or manufacturing defects you have legal rights against the retailer of this product. Your legal rights are not limited in any way by our warranty detailed below.

The warranty for this product is 3 years from the date of purchase. The warranty period begins on the date of purchase. Keep the original sales receipt in a safe location as this document is required as proof of purchase.

Any damage or defects already present at the time of purchase must be reported without delay after unpacking the product.

Should the product show any fault in materials or manufacture within 3 years from the date of purchase, we will repair or replace it – at our choice – free of charge to you. The warranty period is not extended as a result of a claim being granted. This also applies to replaced and repaired parts.

This warranty becomes void if the product has been damaged, or used or maintained improperly.

The warranty covers material or manufacturing defects. This warranty does not cover product parts subject to normal wear and tear, thus considered consumables (e.g. batteries, rechargeable batteries, tubes, cartridges), nor damage to fragile parts, e.g. switches or glass parts.

#### ● Warranty claim procedure

To ensure quick processing of your case, please observe the following instructions:

Please have the till receipt and the item number (IAN 487938\_2407) available as proof of purchase.

You will find the item number on the rating plate, an engraving on the front page of the instructions for use (bottom left), or as a sticker on the rear or bottom of the product.

If functional or other defects occur, please contact the service department listed either by telephone or by e-mail.

You can return a defective product to us free of charge to the service address that will be provided to you. Ensure that you enclose the proof of purchase (till receipt) and information about what the defect is and when it occurred.

#### ● Service

**GB** **Service Great Britain**  
Tel.: 0800 0569216  
E-Mail: owim@lidl.co.uk

CE

Legenda použitých piktogramov	
	Skratuvzdorný bezpečnostný transformátor
	Nezávislý prevádzkový prístroj
	Vhodné len pre interiér
	Striedavý prúd/napätie
	Značka CE potvrdzuje zhodu so smernicami EÚ vzťahujúcimi sa na tento výrobok.
	Trieda ochrany II
	Jednosmerný prúd/napätie
	Nestmievateľné
	Odstup od ožarovaných povrchov: minimálne 0,1 m
	Bezpečnostné upozornenia
	Manipulačné pokyny

### Upínacia LED lampa

#### ● Úvod

Blahoželáme Vám ku kúpe Vášho nového výrobku. Rozhodli ste sa pre veľmi kvalitný výrobok. Návod na obsluhu je súčasťou tohto výrobku. Obsahuje dôležité upozornenia týkajúce sa bezpečnosti, používania a likvidácie. Skôr ako začnete výrobok používať, oboznámte sa so všetkými pokynmi k obsluhu a bezpečnosti. Výrobok používajte iba v súlade s popisom a v uvedených oblastiach používania. V prípade postúpenia výrobku ďalším osobám odovzdajte aj všetky dokumenty patriace k výrobku.

#### ● Štandardné použitie

Výrobok je určený výhradne na používanie v oblasti interiéru, v suchých a uzatvorených miestnostiach. Výrobok nie je určený na podnikateľské účely.

#### ● Popis častí

- |                                     |                           |
|-------------------------------------|---------------------------|
| <b>1</b> Flexibilné rameno svetidla | <b>4</b> Prívodné vedenie |
| <b>2</b> Upínacie zariadenie        | <b>5</b> Sieťový adaptér  |
| <b>3</b> Za/vypínač                 |                           |

the hazards involved. Children shall not play with the product. Cleaning and user maintenance shall not be made by children without supervision.

- This product is designed for use indoors only, in dry and enclosed rooms.
- The product is not suitable for attaching to tubular objects. Failure to observe this advice could lead to the product falling and possible damage to the product and/or injury.
- FIRE HAZARD!** Fit the product so that it is at least 0.1 m away from the material illuminated. Fire can result from the development of too much heat.
- The LED is not dimmable. The luminaires is not compatible with any dimmer.
- If the LED fail at the end of their lives, the entire product must be repaired by qualified electrician.

### Avoid the danger of death from electric shock!

- Before use, ensure that the mains voltage available is the same as the required operating voltage for the product (200–240V~).
- Before connecting the product to the mains you should always check the product and the power cable **4** for any damage. A damaged product represents the danger of death from electric shock.
- Do not use the product if you find any damage.
- Please consult a specialist electrician if you discover any damage or problems with the product, or for the performance of repairs to the product.
- Never open any of the electrical equipment or insert any objects into it. Such interventions represent the danger of death from electric shock.
- It is essential that the product does not come into contact with water or other liquids.
- Protect the power cable **4** from sharp edges, mechanical strain and hot surfaces.
- Never use the product in the immediate vicinity of a bathtub, shower or swimming pool.
- Do not look directly into the light or its reflection. Do not aim the light directly at people. This could produce glare, leading to accidents.
- If direct or reflected light strikes your eyes, close them and move your head immediately out of the light.
- Operate the product only with supplied mains adapter. Please note that any damage caused through the use of a different adapter is excluded from the warranty.
- Never touch the mains adapter **5** with moist or wet hands.
- Unplug the mains adapter **5** from the socket if the product will not be used for an extended period (e.g. whilst on holiday).
- The product becomes hot during operation. Allow the product to cool before you touch them.

#### ● Technické údaje

Celkový výkon: 3,5W  
Výkon LED: 2,7W

#### LED upínacie svietidlo:

LED diódy: 6 LED  
LED diódy nemôže vymeniť konečný spotrebiteľ.  
Tento výrobok obsahuje svetelné zdroje triedy energetickej účinnosti F.

#### Sieťový adaptér:

nominálne napätie, primárne: 200–240V~ 50/60Hz  
nominálne napätie, sekundárne: 9–12V, 0,26 A, 3,12 W  
Trieda ochrany: II/

Model č.: HS1200260V

SELV: Ochranné nízke napätie (Safety extra low voltage)  
ta: Maximálna teplota okolia  
tc: Teplota schránky v uvedenom bode

#### ● Obsah dodávky

- 1 upínacia LED lampa
- 1 návod na obsluhu

#### ● Bezpečnosť

### Bezpečnostné upozornenia

PRED POUŽÍVANÍM VÝROBKU SI PREČÍTAJTE NÁVOD NA POUŽÍVANIE! VŠETKY BEZPEČNOSTNÉ UPOZORNENIA A POKYNY USCHOVAJTE PRE NESKORŠIE POUŽITIE!

- VAROVANIE! NEBEZPEČENSTVO OHROZENIA ŽIVOTA A NEBEZPEČENSTVO NEHODY PRE MALÉ DETI A DETI!** Nikdy nenechávajte deti bez dozoru s obalovým materiálom. Existuje nebezpečenstvo zadusenia obalovým materiálom. Deti často podceňujú nebezpečenstvo. Držte deti vždy v bezpečnej vzdialenosti od výrobku.
- Tento výrobok nie je na hranie, nepatrí do rúk deťom. Deti nedokážu rozoznať nebezpečenstvá, ktoré vznikajú pri manipulácii s výrobkom.
- Tento výrobok môžu používať deti od 8 rokov, ako aj osoby so zníženými psychickými, senzorickými alebo mentálnymi schopnosťami alebo s nedostatkom skúseností a vedomostí, ak sú pod dozorom, alebo ak boli poučené ohľadom bezpečného používania výrobku, a ak porozumeli nebezpečenstvám spojeným s jeho používaním. Deti sa s výrobkom nesmú hrať. Čistenie a údržbu nesmú vykonávať deti bez dozoru.

GB

GB

GB

SK

SK

