

DE AT CH GB IE

FAHRRAD-BÜGEL-SCHLOSS
Gebrauchsanweisung

FR BE

ANTIVOL EN U POUR VÉLO
Notice d'utilisation

PL

ZAPIĘCIE ROWEROWE U-LOCK
Instrukcja użytkownika

SK

VISIACA ZÁMKA NA BICYKEL
Návod na používanie

DK

BØJLELÅS TIL CYKEL
Brugervejledning

HU

KERÉKPÁRLAKAT
Használati útmutató

IAN 438746_2304

DE AT CH GB IE
FR BE NL PL CZ
SK ES DK IT HU



PDF ONLINE
www.lidl-service.com

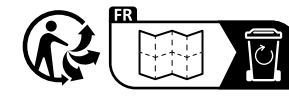

DELTA-SPORT HANDELSKONTOR GMBH
Wragelkamp 6 • 22397 Hamburg
GERMANY

11/2023
DeltaSportNr.: FS 13489

IAN 438746_2304

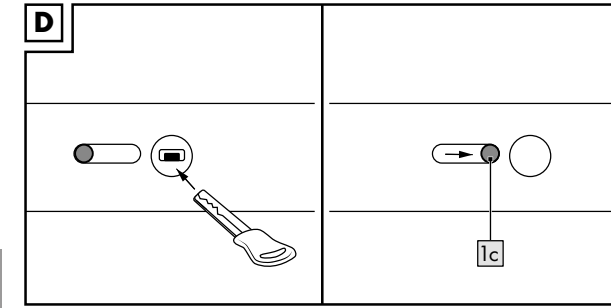
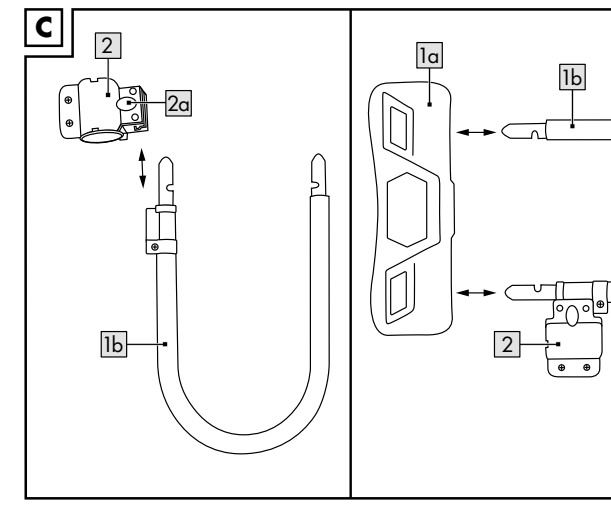
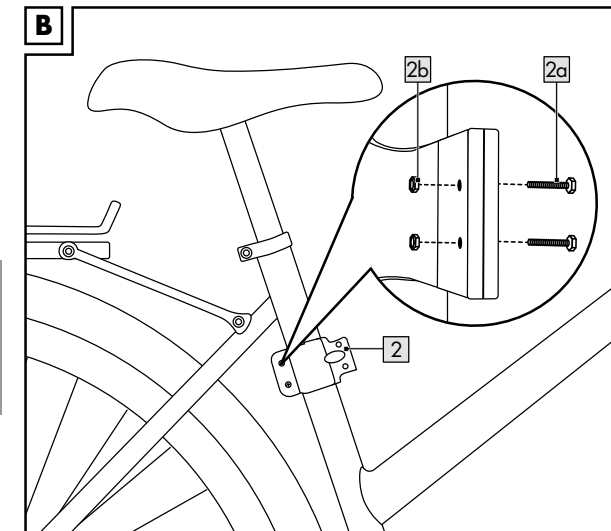
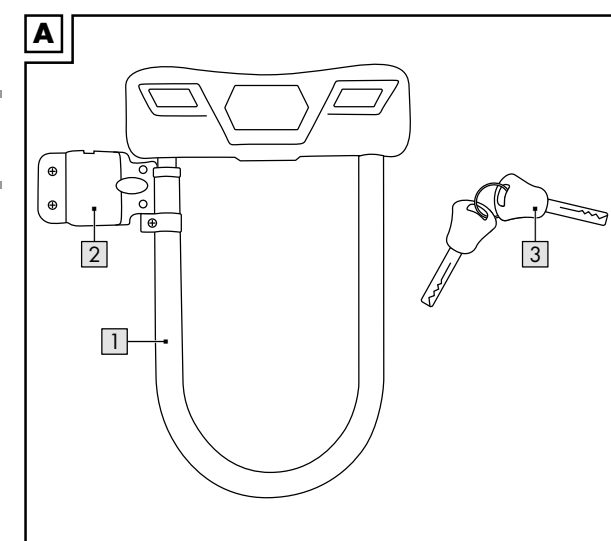

Herzlichen Glückwunsch! Mit Ihrem Kauf haben Sie sich für einen hochwertigen Artikel entschieden. Machen Sie sich vor der ersten Verwendung mit dem Artikel vertraut.

Lesen Sie hierzu aufmerksam die nachfolgende Gebrauchsanweisung.

Benutzen Sie den Artikel nur wie beschrieben und für die angegebenen Einsatzbereiche. Bewahren Sie diese Gebrauchsanweisung gut auf. Händigen Sie alle Unterlagen bei Weitergabe des Artikels an Dritte ebenfalls mit aus.

Lieferumfang (Abb. A)
1 x Fahrrad-Bügel-Schloss (1)
1 x Rahmhalterung (2)
2 x Schlüssel (3)
1 x Gebrauchsanweisung

Technische Daten
Bügelinnenmaß: ca. 10,6 cm
Herstellungsdatum (Monat/Jahr): 11/2023

Bestimmungsgemäße Verwendung
Dieser Artikel dient zur Sicherung von Fahrrädern und ist für den privaten Gebrauch konzipiert. Der Artikel ist nicht für den gewerblichen Gebrauch bestimmt.

Montage am Fahrradrahmen (Abb. B)
Montieren Sie die Rahmhalterung (2) an einer geeigneten Stelle am Fahrradrahmen. Achtung! Weder die Beinfreiheit, das Drehen der Räder oder die Lenkung des Fahrrades darf durch die Montage des Artikels beeinträchtigt werden.

1. Entfernen Sie die Schrauben (2a) und die Muttern (2b) der Rahmhalterung.
2. Stecken Sie die Rahmhalterung an einer geeigneten Stelle um den Fahrradrahmen.
3. Sichern Sie die Rahmhalterung, indem Sie die Schrauben und die Muttern wieder einsetzen und mit einem Kreuzschlitz-Schraubendreher (nicht im Lieferumfang enthalten) fest anziehen.

Hinweis: Achten Sie darauf, dass die Muttern sich in den Aussparungen befinden.

Artikel transportieren
Wenn Sie den Artikel nicht verwenden, fixieren Sie das Schloss immer in der Rahmhalterung, wie in der Abb. C dargestellt.

Hinweis: Um den Bügel wieder zu lösen, drücken Sie den Knopf (2a) auf der Rahmhalterung und ziehen Sie den Bügel heraus.
2. Stecken Sie die Schlossbasis (1a) auf den Bügel und verschließen Sie das Schloss mit einem Schlüssel (Abb. C).

Achtung! Der Artikel darf sich während der Fahrt nicht in der Nähe von Fahrradspeichen befinden. Ansonsten besteht Unfallgefahr! Achten Sie darauf, dass der Artikel während der Fahrt fest verschlossen ist und sich nicht lösen kann. Sonst besteht Sturzgefahr!

Verwendung
1. Öffnen Sie das Fahrrad-Bügel-Schloss (1), indem Sie einen Schlüssel (3) in das Schloss einführen.
2. Drehen Sie den Schlüssel im Uhrzeigersinn und ziehen Sie den Bügel (1b) aus der Schlossbasis (1a).
3. Legen Sie den Artikel durch den Fahrradrahmen und Vorder-/Hinterrad und um einen nicht farbbewegbaren Gegenstand, bspw. einem Laternenpfahl, Pfosten oder einen im Boden verankerten Fahrradständer.

Lagerung, Reinigung
Lagern Sie den Artikel bei Nichtbenutzung immer trocken und sauber bei Raumtemperatur. Nur mit einem feuchten Reinigungstuch reinigen und anschließend trocken wischen. WICHTIG! Nie mit scharfen Reinigungsmitteln reinigen. Entfernen Sie groben Schmutz vom Schloss und ölen Sie es je nach Bedarf regelmäßig mit einem im Fachhandel erhältlichen Öl.

Hinweise zur Entsorgung
Entsorgen Sie den Artikel und die Verpackungsmaterialien entsprechend den aktuellen örtlichen Vorschriften. Bewahren Sie die Verpackungsmaterialien (wie z. B. Folienbeutel) für Kinder unerschickbar auf. Weitere Informationen zur Entsorgung des ausgedienten Artikels erhalten Sie bei Ihrer Gemeinde- oder Stadtverwaltung. Entsorgen Sie den Artikel und die Verpackung umweltschonend. Der Recycling-Code dient der Kennzeichnung verschiedener Materialien (Recycling). Der Code besteht aus einem Recyclingsymbol für den Wertungskreislauf und einer Nummer, die das Material kennzeichnet.

Hinweise zur Garantie und Serviceabwicklung
Der Artikel wurde mit großer Sorgfalt und unter ständiger Kontrolle produziert. DELTA-SPORT HANDELSKONTOR GmbH räumt privaten Endkunden auf diesen Artikel drei Jahre Garantie ab Kaufdatum (Garantierfrist) nach Maßgabe der folgenden Bestimmungen ein. Die Garantie gilt nur für Material- und Verarbeitungsfehler. Die Garantie erstreckt sich nicht auf Teile, die der normalen Abnutzung unterliegen und deshalb als Verschleißteile anzusehen sind (z. B. Batterien) sowie nicht auf zerbrechliche Teile, z. B. Schalter, Akkus oder Teile, die aus Glas gefertigt sind. Ansprüche aus dieser Garantie sind ausgeschlossen, wenn der Artikel unsachgemäß oder missbräuchlich oder nicht im Rahmen der vorgesehenen Bestimmung oder des vorgesehenen Nutzungsumfanges verwendet wurde oder Vorgaben in der Anleitung/Ausweisung nicht beachtet wurden, es sei denn, der Endkunde weist nach, dass ein Material- oder Verarbeitungsfehler vorliegt, der nicht auf einem der vorgenannten Umstände beruht. Ansprüche aus der Garantie können nur innerhalb der Garantierfrist unter Vorlage des Originalkassenbelegs geltend gemacht werden. Bitte bewahren Sie deshalb den Originalkassenbeleg auf. Die Garantierfrist wird durch etwaige Reparaturen aufgrund der Garantie, gesetzlicher Gewährleistung oder Kulanz nicht verlängert. Dies gilt auch für ersetzte und reparierte Teile. Bitte wenden Sie sich bei Beanstandungen zunächst an die untenstehende Service-Hotline oder setzen Sie sich per E-Mail mit uns in Verbindung. Liegt ein Garantiefall vor, wird der Artikel von uns - nach unserer Wahl - für Sie kostenlos repariert, ersetzt oder der Kaufpreis erstattet. Weitere Rechte aus der Garantie bestehen nicht. Ihre gesetzlichen Rechte, insbesondere Gewährleistungsansprüche gegenüber dem jeweiligen Verkäufer, werden durch diese Garantie nicht eingeschränkt.

Hinweise zur Entsorgung
Entsorgen Sie den Artikel und die Verpackungsmaterialien entsprechend den aktuellen örtlichen Vorschriften. Bewahren Sie die Verpackungsmaterialien (wie z. B. Folienbeutel) für Kinder unerschickbar auf. Weitere Informationen zur Entsorgung des ausgedienten Artikels erhalten Sie bei Ihrer Gemeinde- oder Stadtverwaltung. Entsorgen Sie den Artikel und die Verpackung umweltschonend. Der Recycling-Code dient der Kennzeichnung verschiedener Materialien (Recycling). Der Code besteht aus einem Recyclingsymbol für den Wertungskreislauf und einer Nummer, die das Material kennzeichnet.

Technical data
U-bolt internal dimensions: approx. 10,6cm
Date of manufacture (month/year): 11/2023
Date of fabrication (mois/année) : 11/2023

Intended use
This product is used to secure bicycles and is designed for private use. The product is not intended for commercial use.

Mounting on the bicycle frame (Fig. B)
Mount the frame bracket (2) at a suitable location on the bicycle frame.
Warning! Legroom, the turning of the wheels and the steering of the bicycle may not be impaired by the mounting of the product.
1. Remove the screws (2a) and the nuts (2b) of the frame bracket.
2. Place the frame bracket at a suitable location around the bicycle frame.
3. Secure the frame bracket by reattaching the screws and nuts, and tightening them with a Phillips screwdriver (not included in the package contents).

Notes on the guarantee and service handling
The product was produced with great care and under continuous quality control. DELTA-SPORT HANDELSKONTOR GmbH gives private end customers a three-year guarantee on this product from the date of purchase (guarantee period) in accordance with the following provisions.

Technical data
U-bolt internal dimensions: approx. 10,6cm
Date of manufacture (month/year): 11/2023
Date of fabrication (mois/année) : 11/2023

Intended use
This product is used to secure bicycles and is designed for private use. The product is not intended for commercial use.

Mounting on the bicycle frame (Fig. B)
Mount the frame bracket (2) at a suitable location on the bicycle frame.
Warning! Legroom, the turning of the wheels and the steering of the bicycle may not be impaired by the mounting of the product.
1. Remove the screws (2a) and the nuts (2b) of the frame bracket.
2. Place the frame bracket at a suitable location around the bicycle frame.
3. Secure the frame bracket by reattaching the screws and nuts, and tightening them with a Phillips screwdriver (not included in the package contents).

Notes on the guarantee and service handling
The product was produced with great care and under continuous quality control. DELTA-SPORT HANDELSKONTOR GmbH gives private end customers a three-year guarantee on this product from the date of purchase (guarantee period) in accordance with the following provisions.

Technical data
U-bolt internal dimensions: approx. 10,6cm
Date of manufacture (month/year): 11/2023
Date of fabrication (mois/année) : 11/2023

Intended use
This product is used to secure bicycles and is designed for private use. The product is not intended for commercial use.

Mounting on the bicycle frame (Fig. B)
Mount the frame bracket (2) at a suitable location on the bicycle frame.
Warning! Legroom, the turning of the wheels and the steering of the bicycle may not be impaired by the mounting of the product.
1. Remove the screws (2a) and the nuts (2b) of the frame bracket.
2. Place the frame bracket at a suitable location around the bicycle frame.
3. Secure the frame bracket by reattaching the screws and nuts, and tightening them with a Phillips screwdriver (not included in the package contents).

Notes on the guarantee and service handling
The product was produced with great care and under continuous quality control. DELTA-SPORT HANDELSKONTOR GmbH gives private end customers a three-year guarantee on this product from the date of purchase (guarantee period) in accordance with the following provisions.

Technical data
U-bolt internal dimensions: approx. 10,6cm
Date of manufacture (month/year): 11/2023
Date of fabrication (mois/année) : 11/2023

Intended use
This product is used to secure bicycles and is designed for private use. The product is not intended for commercial use.

Mounting on the bicycle frame (Fig. B)
Mount the frame bracket (2) at a suitable location on the bicycle frame.
Warning! Legroom, the turning of the wheels and the steering of the bicycle may not be impaired by the mounting of the product.
1. Remove the screws (2a) and the nuts (2b) of the frame bracket.
2. Place the frame bracket at a suitable location around the bicycle frame.
3. Secure the frame bracket by reattaching the screws and nuts, and tightening them with a Phillips screwdriver (not included in the package contents).

Notes on the guarantee and service handling
The product was produced with great care and under continuous quality control. DELTA-SPORT HANDELSKONTOR GmbH gives private end customers a three-year guarantee on this product from the date of purchase (guarantee period) in accordance with the following provisions.

Technical data
U-bolt internal dimensions: approx. 10,6cm
Date of manufacture (month/year): 11/2023
Date of fabrication (mois/année) : 11/2023

Intended use
This product is used to secure bicycles and is designed for private use. The product is not intended for commercial use.

Mounting on the bicycle frame (Fig. B)
Mount the frame bracket (2) at a suitable location on the bicycle frame.
Warning! Legroom, the turning of the wheels and the steering of the bicycle may not be impaired by the mounting of the product.
1. Remove the screws (2a) and the nuts (2b) of the frame bracket.
2. Place the frame bracket at a suitable location around the bicycle frame.
3. Secure the frame bracket by reattaching the screws and nuts, and tightening them with a Phillips screwdriver (not included in the package contents).

Notes on the guarantee and service handling
The product was produced with great care and under continuous quality control. DELTA-SPORT HANDELSKONTOR GmbH gives private end customers a three-year guarantee on this product from the date of purchase (guarantee period) in accordance with the following provisions.

Technical data
U-bolt internal dimensions: approx. 10,6cm
Date of manufacture (month/year): 11/2023
Date of fabrication (mois/année) : 11/2023

Intended use
This product is used to secure bicycles and is designed for private use. The product is not intended for commercial use.

Mounting on the bicycle frame (Fig. B)
Mount the frame bracket (2) at a suitable location on the bicycle frame.
Warning! Legroom, the turning of the wheels and the steering of the bicycle may not be impaired by the mounting of the product.
1. Remove the screws (2a) and the nuts (2b) of the frame bracket.
2. Place the frame bracket at a suitable location around the bicycle frame.
3. Secure the frame bracket by reattaching the screws and nuts, and tightening them with a Phillips screwdriver (not included in the package contents).

Notes on the guarantee and service handling
The product was produced with great care and under continuous quality control. DELTA-SPORT HANDELSKONTOR GmbH gives private end customers a three-year guarantee on this product from the date of purchase (guarantee period) in accordance with the following provisions.

Technical data
U-bolt internal dimensions: approx. 10,6cm
Date of manufacture (month/year): 11/2023
Date of fabrication (mois/année) : 11/2023

Intended use
This product is used to secure bicycles and is designed for private use. The product is not intended for commercial use.

Mounting on the bicycle frame (Fig. B)
Mount the frame bracket (2) at a suitable location on the bicycle frame.
Warning! Legroom, the turning of the wheels and the steering of the bicycle may not be impaired by the mounting of the product.
1. Remove the screws (2a) and the nuts (2b) of the frame bracket.
2. Place the frame bracket at a suitable location around the bicycle frame.
3. Secure the frame bracket by reattaching the screws and nuts, and tightening them with a Phillips screwdriver (not included in the package contents).

Notes on the guarantee and service handling
The product was produced with great care and under continuous quality control. DELTA-SPORT HANDELSKONTOR GmbH gives private end customers a three-year guarantee on this product from the date of purchase (guarantee period) in accordance with the following provisions.

Technical data
U-bolt internal dimensions: approx. 10,6cm
Date of manufacture (month/year): 11/2023
Date of fabrication (mois/année) : 11/2023

Intended use
This product is used to secure bicycles and is designed for private use. The product is not intended for commercial use.

Mounting on the bicycle frame (Fig. B)
Mount the frame bracket (2) at a suitable location on the bicycle frame.
Warning! Legroom, the turning of the wheels and the steering of the bicycle may not be impaired by the mounting of the product.
1. Remove the screws (2a) and the nuts (2b) of the frame bracket.
2. Place the frame bracket at a suitable location around the bicycle frame.
3. Secure the frame bracket by reattaching the screws and nuts, and tightening them with a Phillips screwdriver (not included in the package contents).

Notes on the guarantee and service handling
The product was produced with great care and under continuous quality control. DELTA-SPORT HANDELSKONTOR GmbH gives private end customers a three-year guarantee on this product from the date of purchase (guarantee period) in accordance with the following provisions.

Technical data
U-bolt internal dimensions: approx. 10,6cm
Date of manufacture (month/year): 11/2023
Date of fabrication (mois/année) : 11/2023

Intended use
This product is used to secure bicycles and is designed for private use. The product is not intended for commercial use.

Mounting on the bicycle frame (Fig. B)
Mount the frame bracket (2) at a suitable location on the bicycle frame.
Warning! Legroom, the turning of the wheels and the steering of the bicycle may not be impaired by the mounting of the product.
1. Remove the screws (2a) and the nuts (2b) of the frame bracket.
2. Place the frame bracket at a suitable location around the bicycle frame.
3. Secure the frame bracket by reattaching the screws and nuts, and tightening them with a Phillips screwdriver (not included in the package contents).

Notes on the guarantee and service handling
The product was produced with great care and under continuous quality control. DELTA-SPORT HANDELSKONTOR GmbH gives private end customers a three-year guarantee on this product from the date of purchase (guarantee period) in accordance with the following provisions.

Technical data
U-bolt internal dimensions: approx. 10,6cm
Date of manufacture (month/year): 11/2023
Date of fabrication (mois/année) : 11/2023

Intended use
This product is used to secure bicycles and is designed for private use. The product is not intended for commercial use.

Mounting on the bicycle frame (Fig. B)
Mount the frame bracket (2) at a suitable location on the bicycle frame.
Warning! Legroom, the turning of the wheels and the steering of the bicycle may not be impaired by the mounting of the product.
1. Remove the screws (2a) and the nuts (2b) of the frame bracket.
2. Place the frame bracket at a suitable location around the bicycle frame.
3. Secure the frame bracket by reattaching the screws and nuts, and tightening them with a Phillips screwdriver (not included in the package contents).

Notes on the guarantee and service handling
The product was produced with great care and under continuous quality control. DELTA-SPORT HANDELSKONTOR GmbH gives private end customers a three-year guarantee on this product from the date of purchase (guarantee period) in accordance with the following provisions.

Technical data
U-bolt internal dimensions: approx. 10,6cm
Date of manufacture (month/year): 11/2023
Date of fabrication (mois/année) : 11/2023

Intended use
This product is used to secure bicycles and is designed for private use. The product is not intended for commercial use.

Mounting on the bicycle frame (Fig. B)
Mount the frame bracket (2) at a suitable location on the bicycle frame.
Warning! Legroom, the turning of the wheels and the steering of the bicycle may not be impaired by the mounting of the product.
1. Remove the screws (2a) and the nuts (2b) of the frame bracket.
2. Place the frame bracket at a suitable location around the bicycle frame.
3. Secure the frame bracket by reattaching the screws and nuts, and tightening them with a Phillips screwdriver (not included in the package contents).

Notes on the guarantee and service handling
The product was produced with great care and under continuous quality control. DELTA-SPORT HANDELSKONTOR GmbH gives private end customers a three-year guarantee on this product from the date of purchase (guarantee period) in accordance with the following provisions.

Technical data
U-bolt internal dimensions: approx. 10,6cm
Date of manufacture (month/year): 11/2023
Date of fabrication (mois/année) : 11/2023

Intended use
This product is used to secure bicycles and is designed for private use. The product is not intended for commercial use.

Mounting on the bicycle frame (Fig. B)
Mount the frame bracket (2) at a suitable location on the bicycle frame.
Warning! Legroom, the turning of the wheels and the steering of the bicycle may not be impaired by the mounting of the product.
1. Remove the screws (2a) and the nuts (2b) of the frame bracket.
2. Place the frame bracket at a suitable location around the bicycle frame.
3. Secure the frame bracket by reattaching the screws and nuts, and tightening them with a Phillips screwdriver (not included in the package contents).

Notes on the guarantee and service handling
The product was produced with great care and under continuous quality control. DELTA-SPORT HANDELSKONTOR GmbH gives private end customers a three-year guarantee on this product from the date of purchase (guarantee period) in accordance with the following provisions.

Technical data
U-bolt internal dimensions: approx. 10,6cm
Date of manufacture (month/year): 11/2023
Date of fabrication (mois/année) : 11/2023

Intended use
This product is used to secure bicycles and is designed for private use. The product is not intended for commercial use.

Mounting on the bicycle frame (Fig. B)
Mount the frame bracket (2) at a suitable location on the bicycle frame.
Warning! Legroom, the turning of the wheels and the steering of the bicycle may not be impaired by the mounting of the product.
1. Remove the screws (2a) and the nuts (2b) of the frame bracket.
2. Place the frame bracket at a suitable location around the bicycle frame.
3. Secure the frame bracket by reattaching the screws and nuts, and tightening them with a Phillips screwdriver (not included in the package contents).

Notes on the guarantee and service handling
The product was produced with great care and under continuous quality control. DELTA-SPORT HANDELSKONTOR GmbH gives private end customers a three-year guarantee on this product from the date of purchase (guarantee period) in accordance with the following provisions.

