

Cabinet with sliding doors

(ES) Armario de puertas correderas
Instrucciones de montaje

(PT) Armário com portas de correr
Instruções de montagem

(GB) Cabinet with sliding doors
Assembly instruction

(IT) Armadio con ante scorrevoli
(MT) Istruzioni per il montaggio

(DE) Schiebetürschrank
(AT) Montageanleitung

(CH)

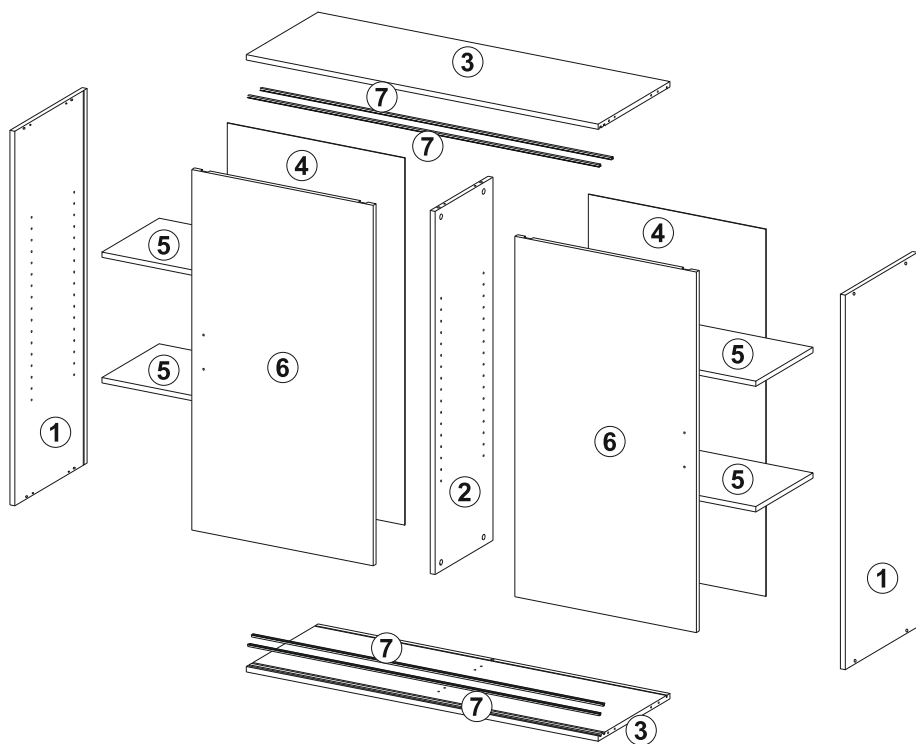

A

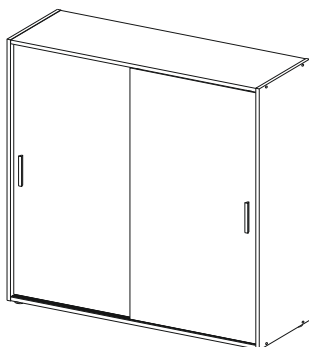

B

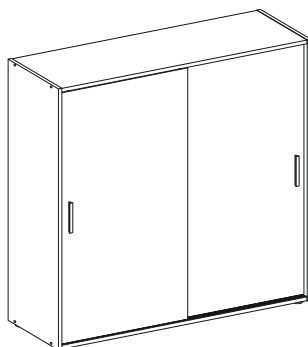

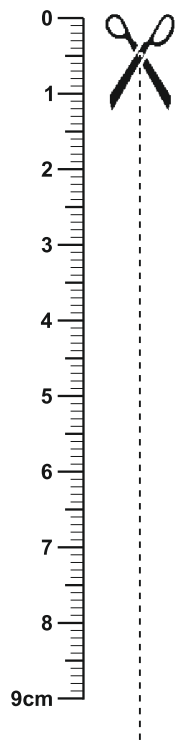

Necesita:
Le servono:
Necessita de:
You need:
Sie benötigen:

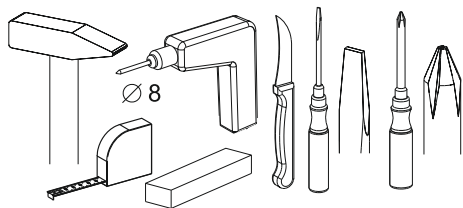

Herrajes / Guarnizioni / Guarnições /
Fittings / Beschläge

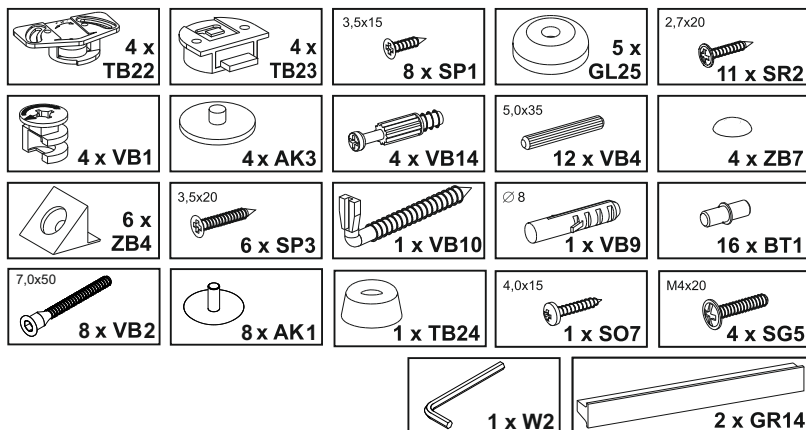

Piezas / Pezzi / Peças / Article / Teile

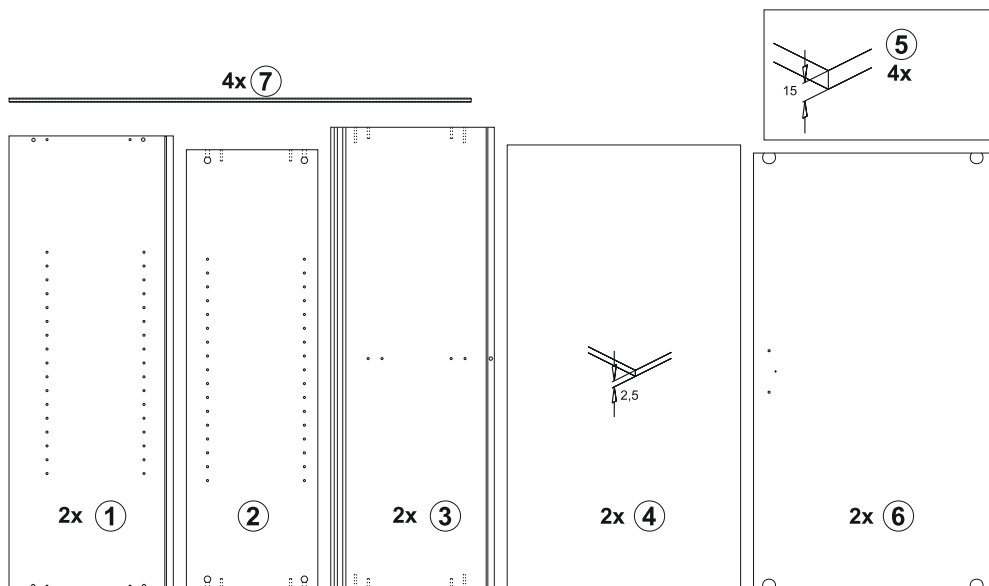

ES **Aviso de seguridad**

Atención: En caso de montaje incorrecto, existe peligro para la seguridad.

¡Se recomienda recurrir a un personal profesional especializado para efectuar el montaje!

Para evitar que se vuelque, utilice este producto con el soporte de pared suministrado.

Indicaciones de mantenimiento

Limpiar sólo con un trapo para el polvo o con un trapo húmedo. No utilizar productos de limpieza abrasivos.

Uso conforme a las disposiciones legales

El producto es utilizable para el área de vivienda privada.

IT **Nota di sicurezza**

Attenzione: Nel caso di montaggio non adeguato c'è pericolo di sicurezza.

Si consiglia il montaggio da personale esperto

Per evitare ribaltamenti, utilizzare questo prodotto con il supporto da parete in dotazione.

Istruzione di cura!

Per favore pulire solo con un panno per rimuovere polvere o con uno straccio umido. Non usare detergenti abrasivi!

Uso secondo le disposizioni

Prodotto addato per uso domestico.

PT **Aviso de segurança**

Atenção: Em caso de montagem incorrecta existe perigo relativamente à segurança

É recomendável recorrer a um pessoal profissional especializado para efectuar a montagem!

Para evitar que tombe, este produto deve ser usado com o suporte de parede fornecido.

Indicação de tratamento!

Limpar apenas com um pano suave ou humedecido. Não utilizar qualquer detergente abrasivo!

Uso de acordo com as disposições legais

O produto é utilizável para a área residencial privada.

-
- (GB) Safety instructions:**
- (INT) Warning: Deficient assembly causes safety risks. Assembling by qualified personnel is recommended.**

To prevent tipping over, use this product with the supplied wall bracket.

Care instructions:

Please do only clean with a duster or a damp cloth. Do not use any scouring agents!

Intended use:

The appliance is intended for household use.

- (DE) Sicherheitshinweis:**
- (AT) Achtung: Bei mangelhafter Montage besteht Gefahr für die Sicherheit.**
- (CH) Aufbau durch fachkundiges Personal empfohlen!**

Um ein Umkippen zu verhindern, ist dieses Produkt mit der mitgelieferten Wandbefestigung zu verwenden!

Pflegehinweis:

Bitte nur mit einem Staubtuch oder einem feuchten Lappen reinigen. Keine scheuernden Putzmittel verwenden!

Bestimmungsgemäße Verwendung:

Produkt nutzbar für den privaten Wohnbereich.

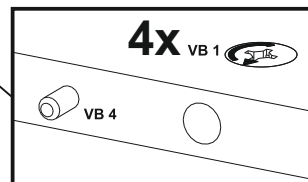
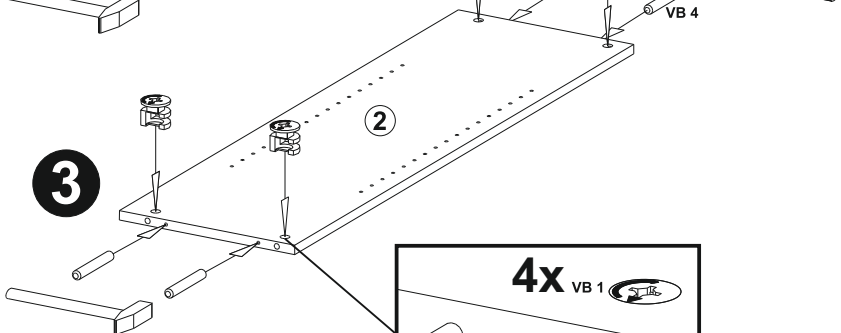
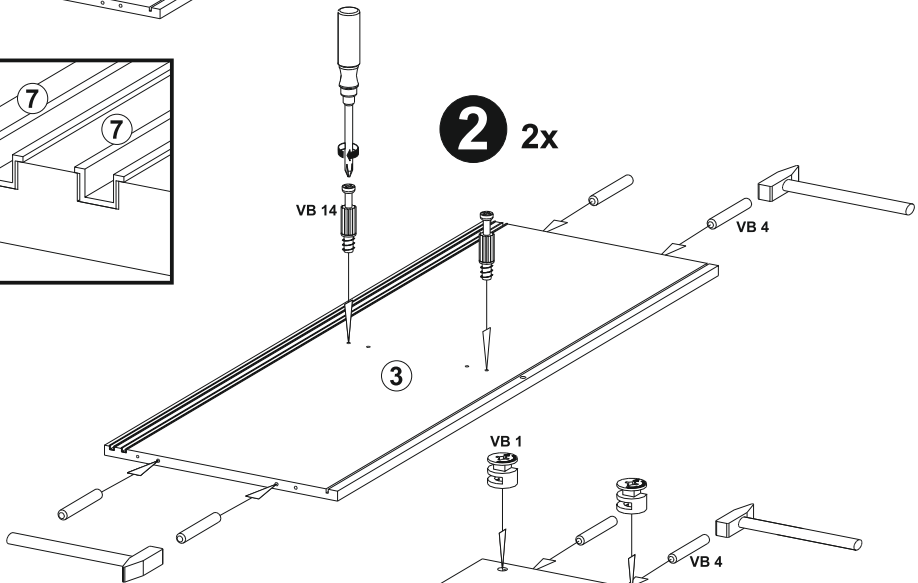
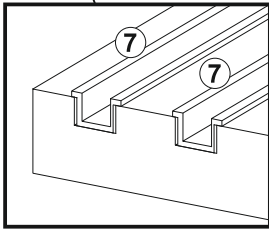
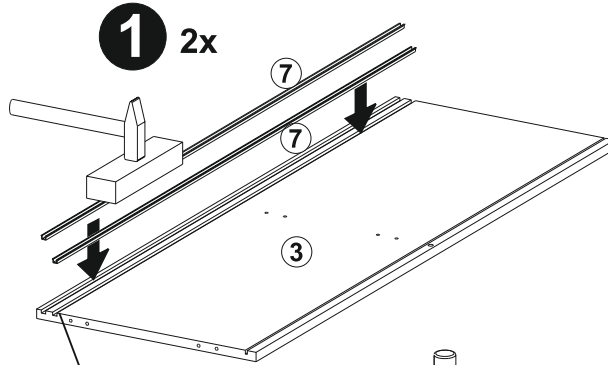
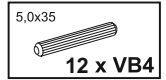
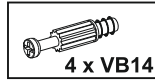
A

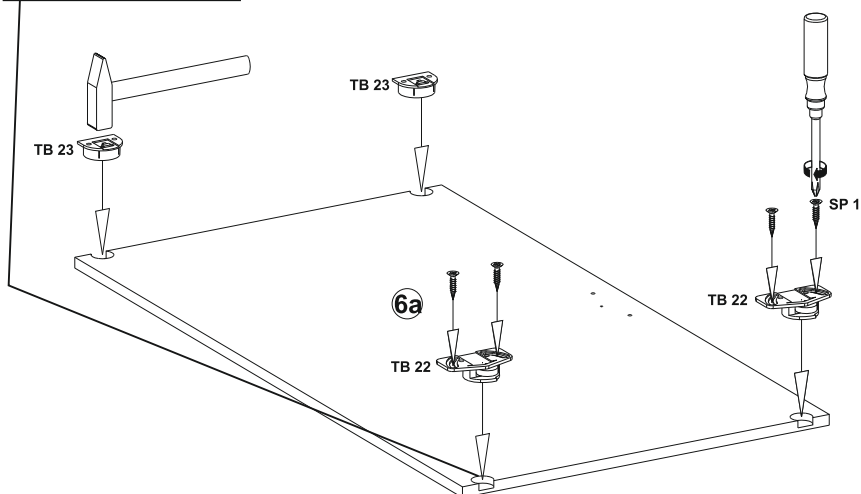
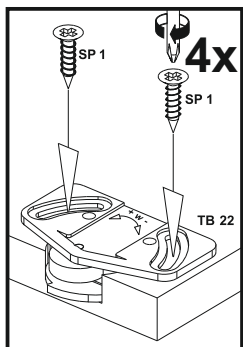
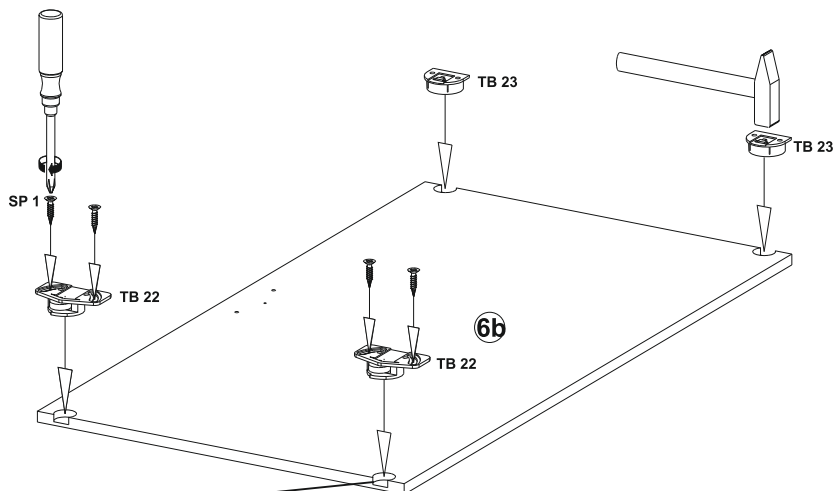
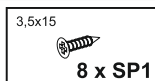
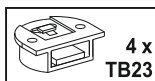

C

7,0x50

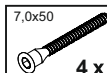

4 x VB2



1 x W2

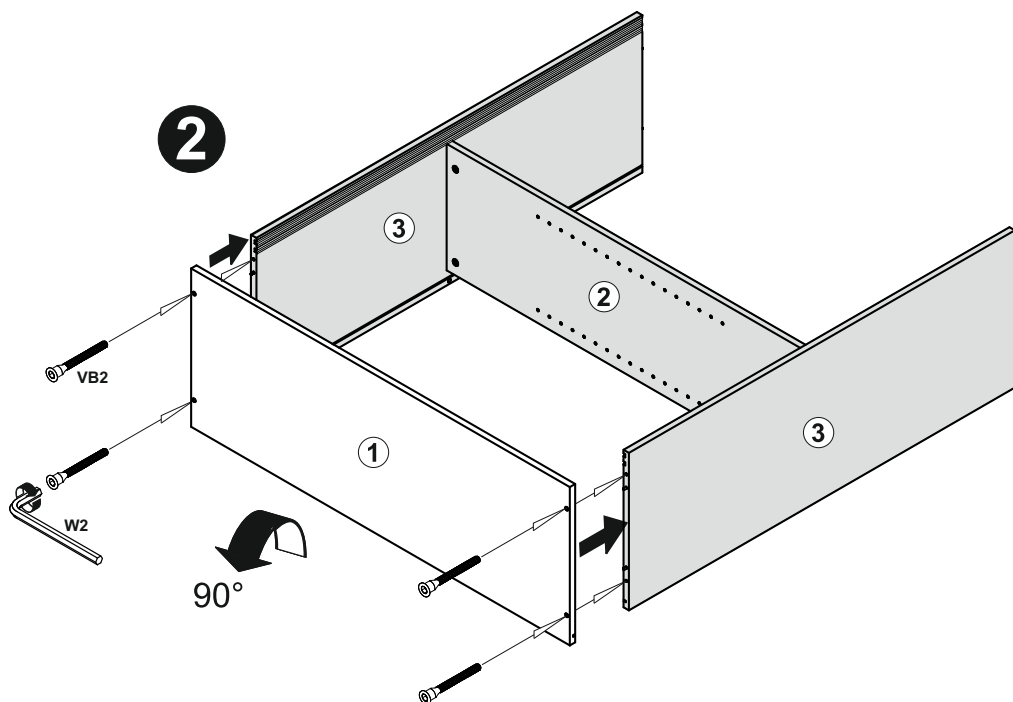
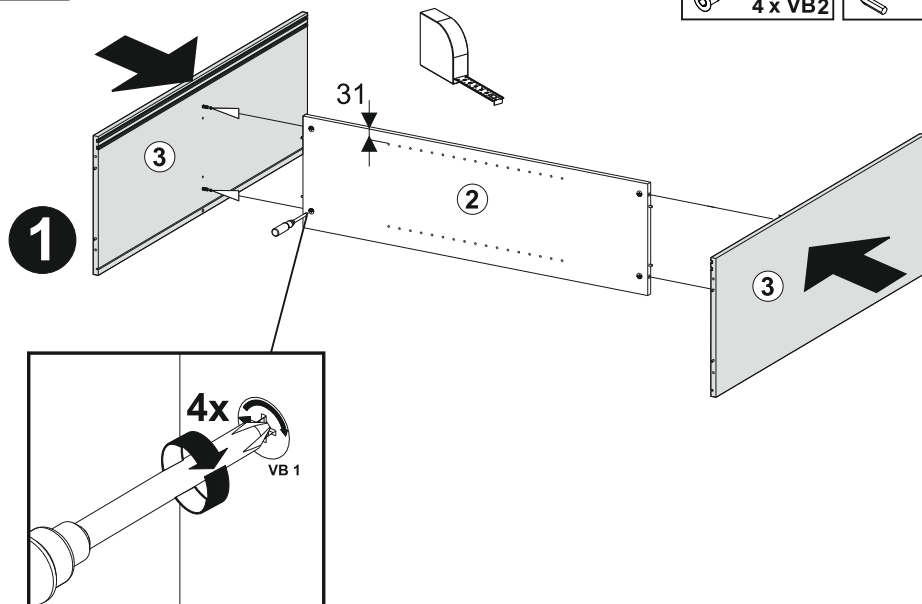

D

7,0x50
4 x VB2

1 x W2

6 x
ZB4

3,5x20
6 x SP3

2,7x20
6 x SR2

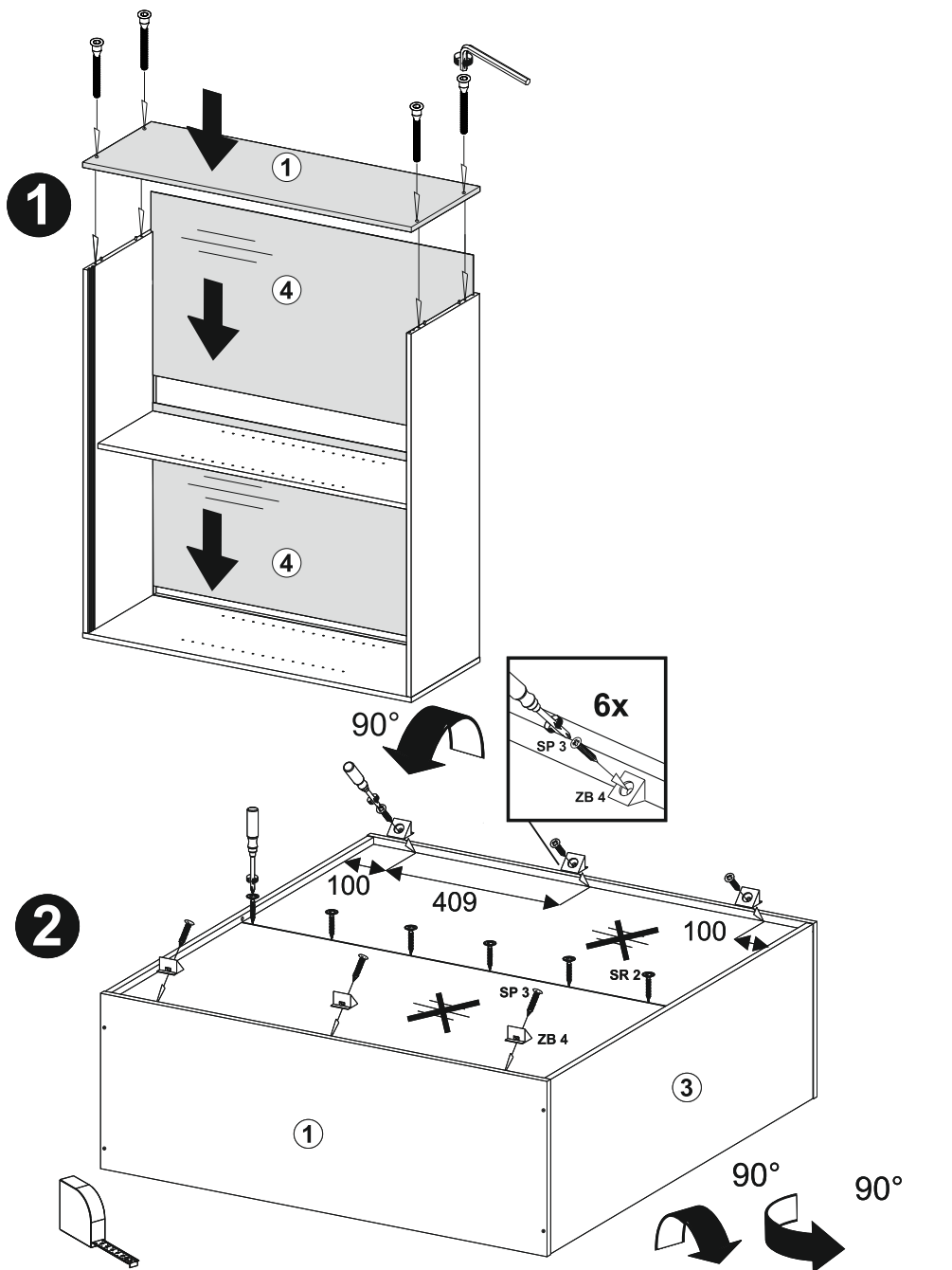

E

5 x
GL25

2,7x20

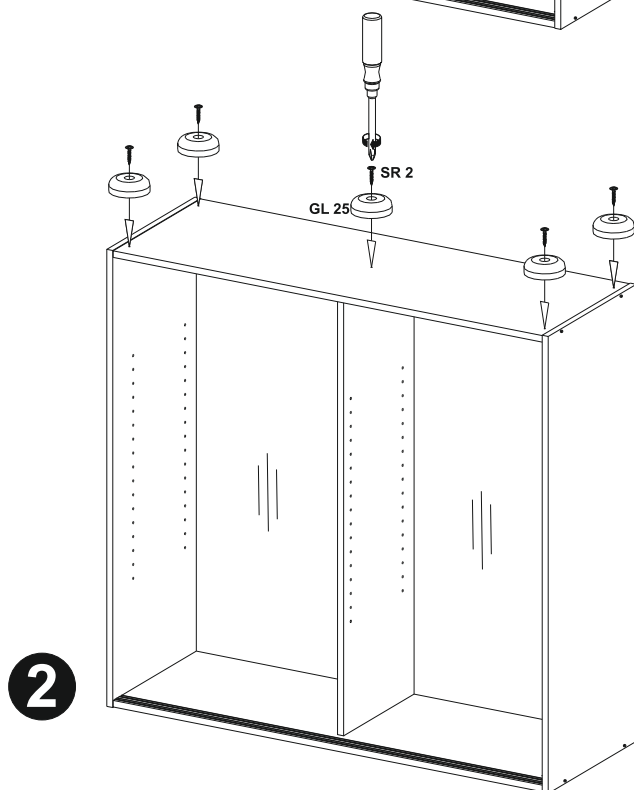
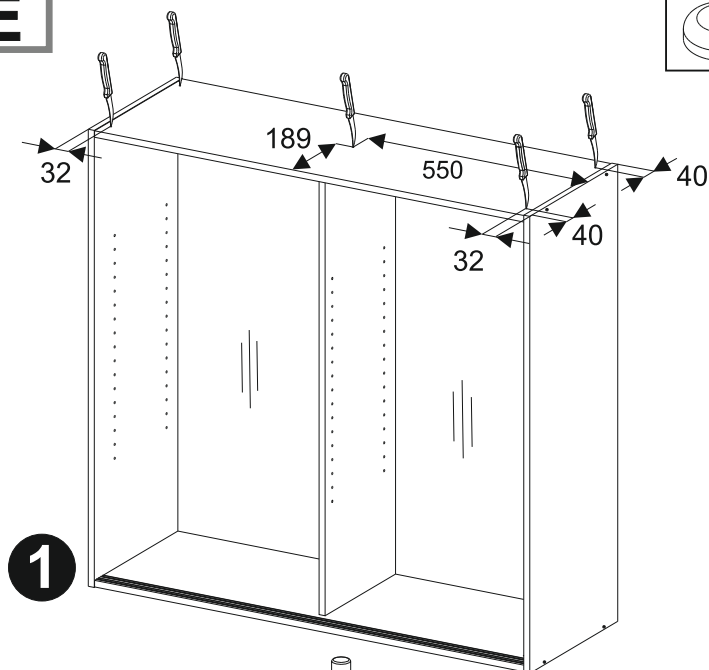
5 x SR2

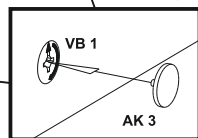
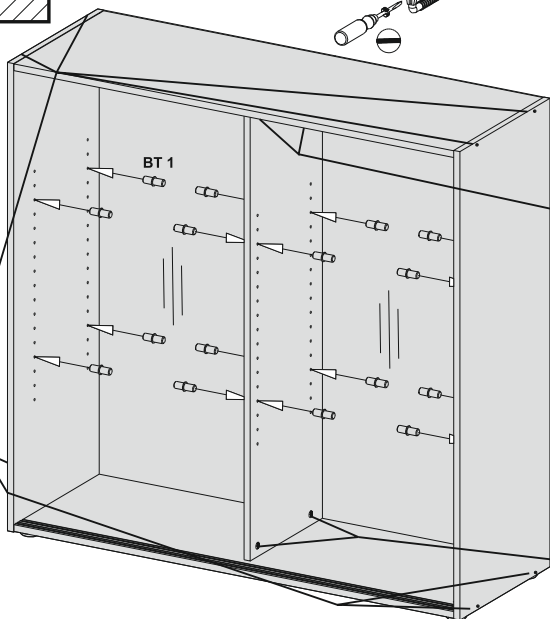
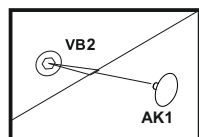
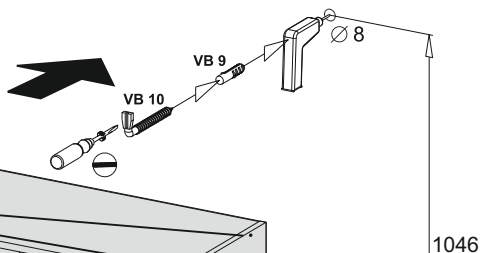
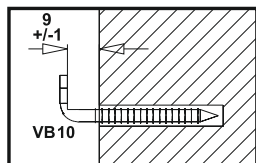
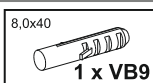
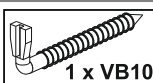
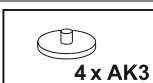
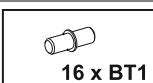
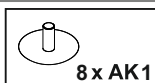



ES

Montaje en pared:

Al emplear material de unión para la fijación de paredes, debe comprobarse la idoneidad del material de soporte.

IT

MT

Montaggio su parete:

Nel caso di mezzi di connessione per il fissaggio della parete il materiale portante deve essere esaminato in vista della sua idoneità.

PT

Montagem em parede:

Em caso de meios de ligação para a fixação na parede, o material de suporte deve ser verificado quando à aptidão.

GB

MT

Wall fixing:

In case of connective devices for the wall mounting, the supporting material must be checked for suitability.

DE

AT

CH

Wandmontage:

Bei Verbindungsmittel für die Wandbefestigung ist das Trägermaterial auf Eignung zu prüfen.

A

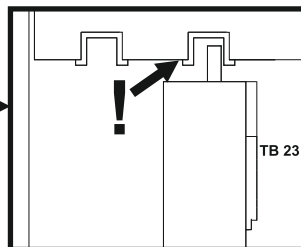
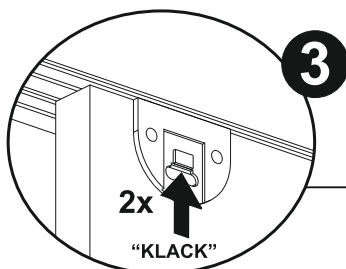
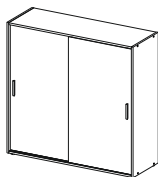

1

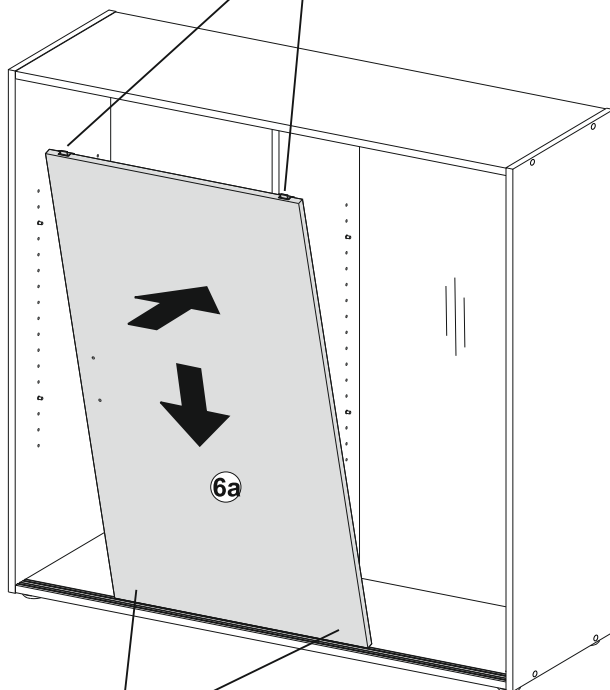

2

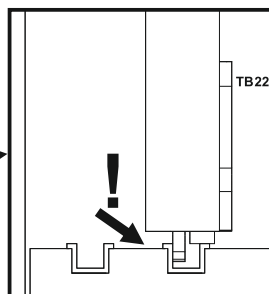
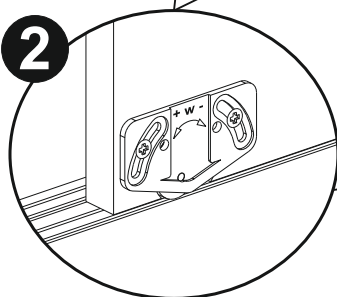

A

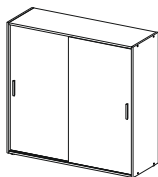

3

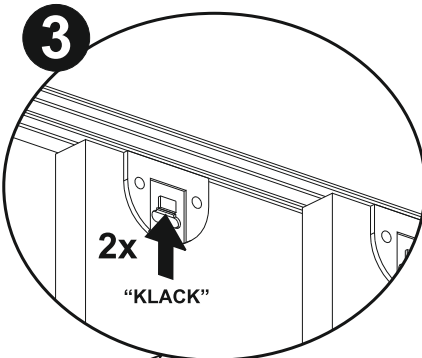

1

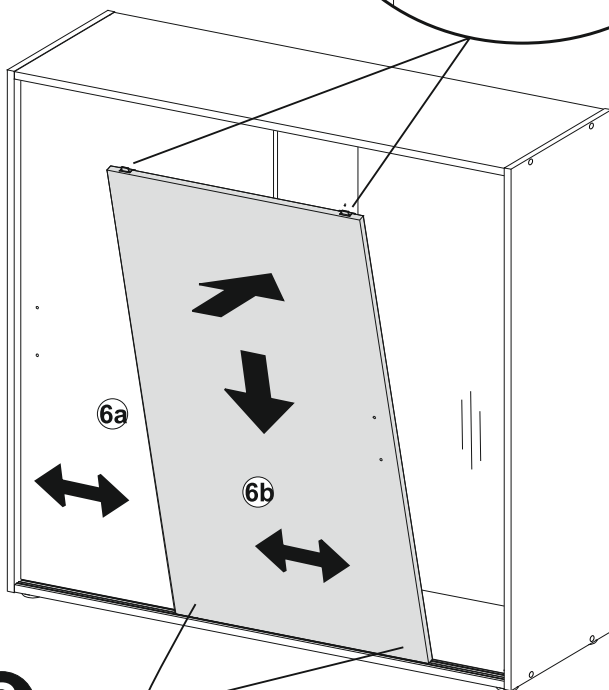

2

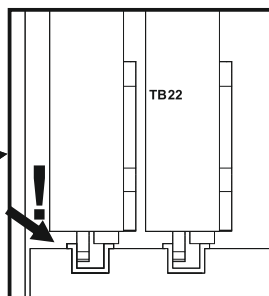
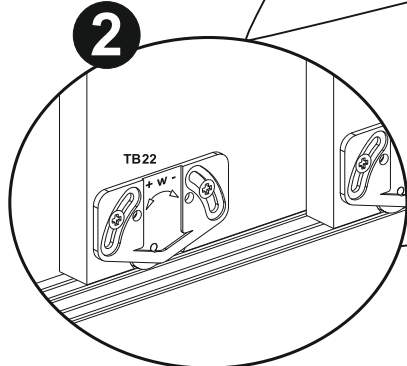

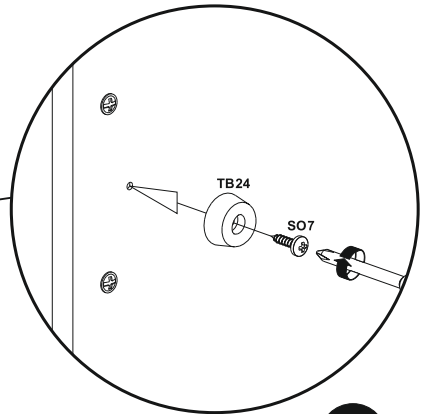
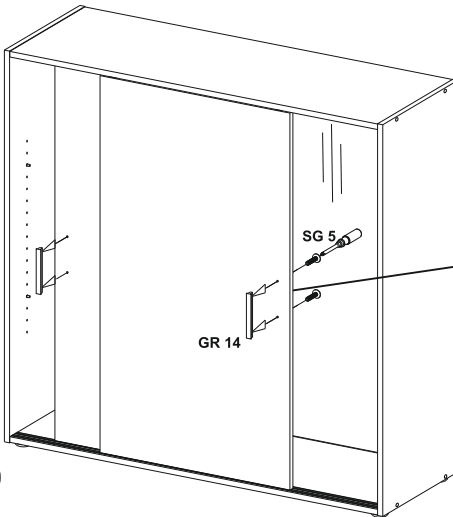
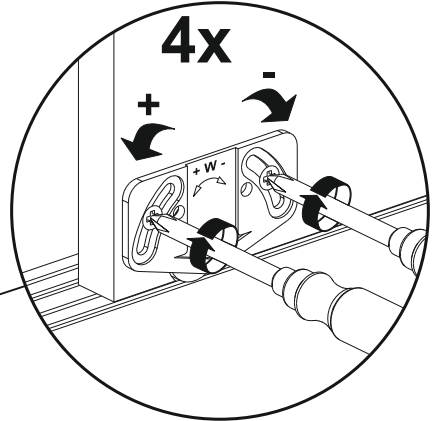
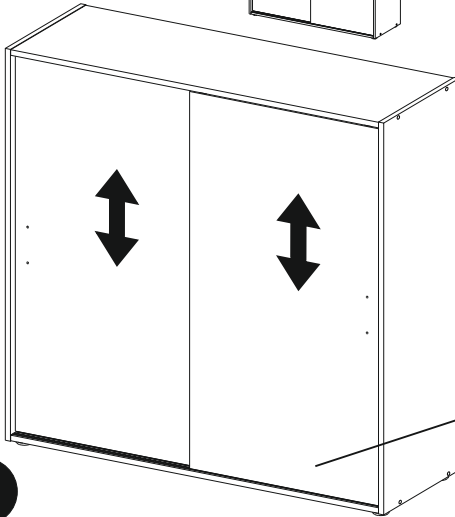
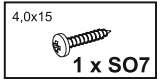
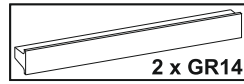
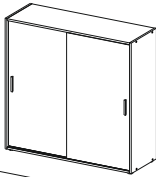
I1**A**

A

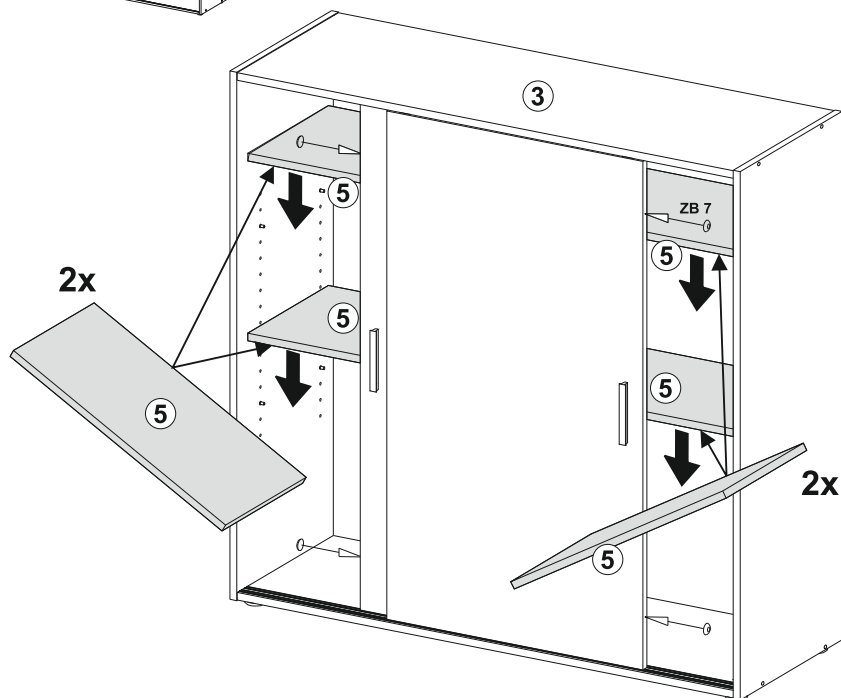
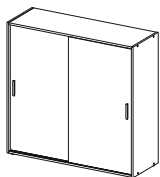

B

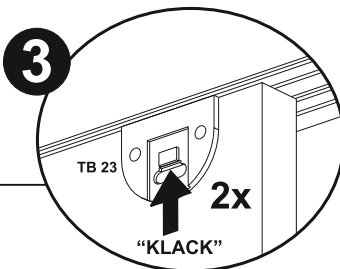
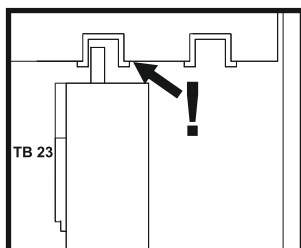
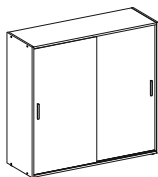

1

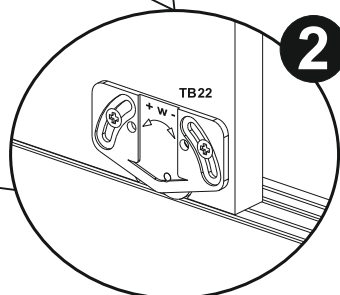
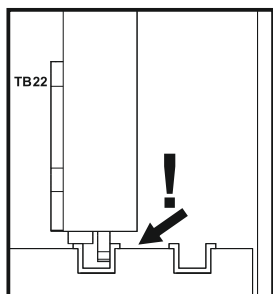
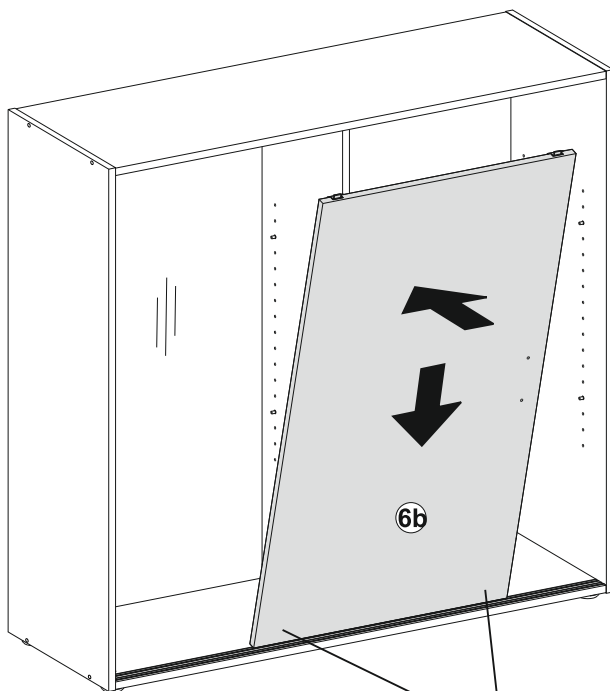

B

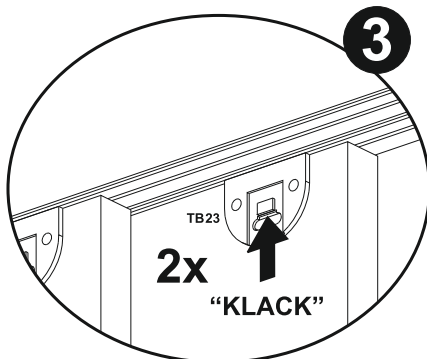
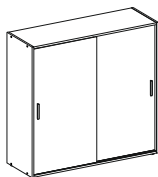

1

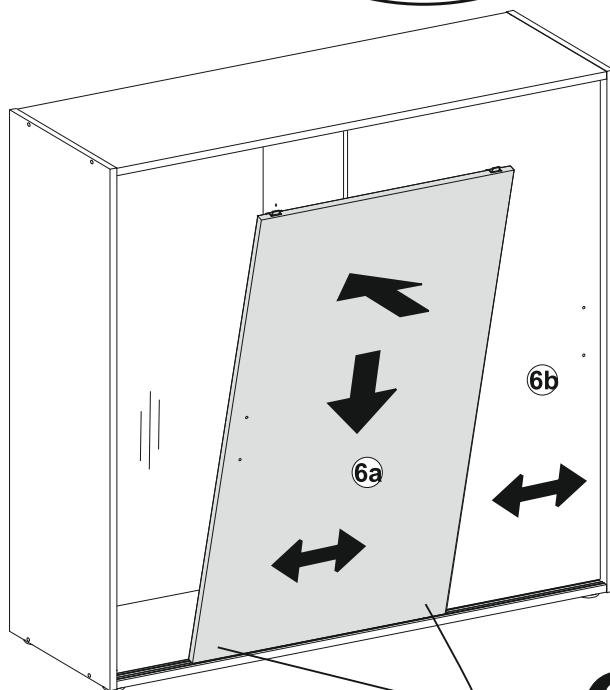

2

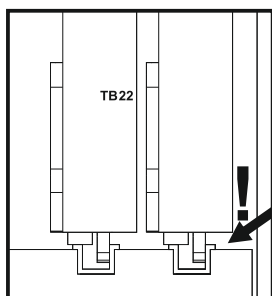
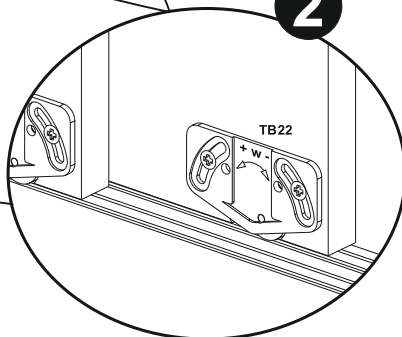

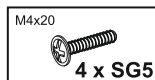
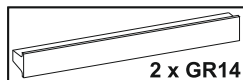
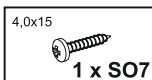
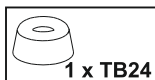

B

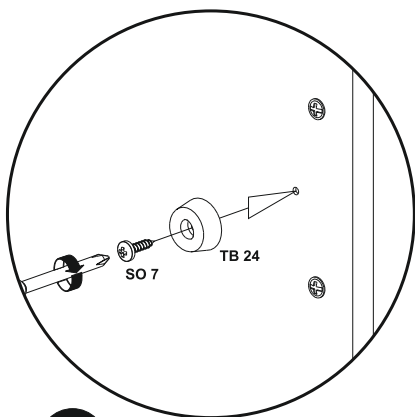
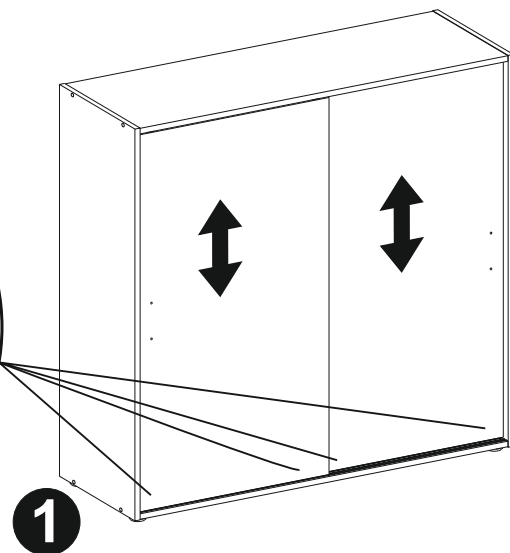
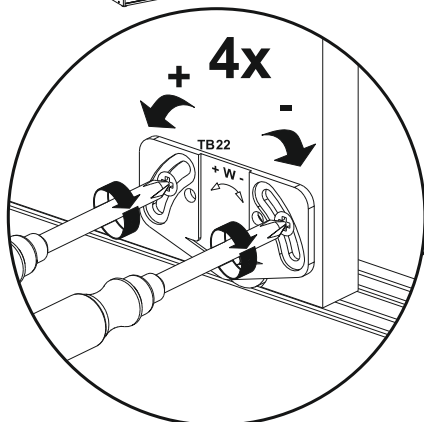
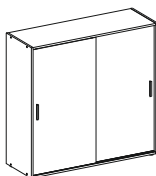

2

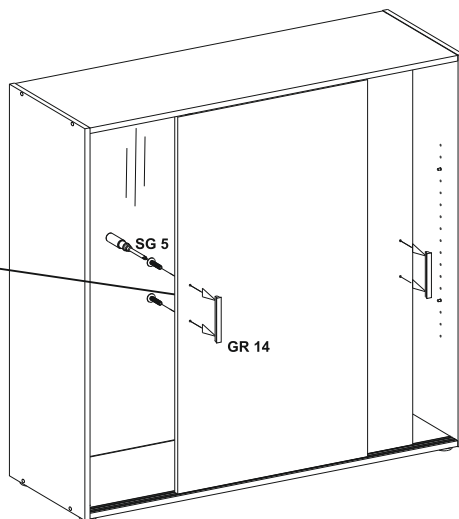

B

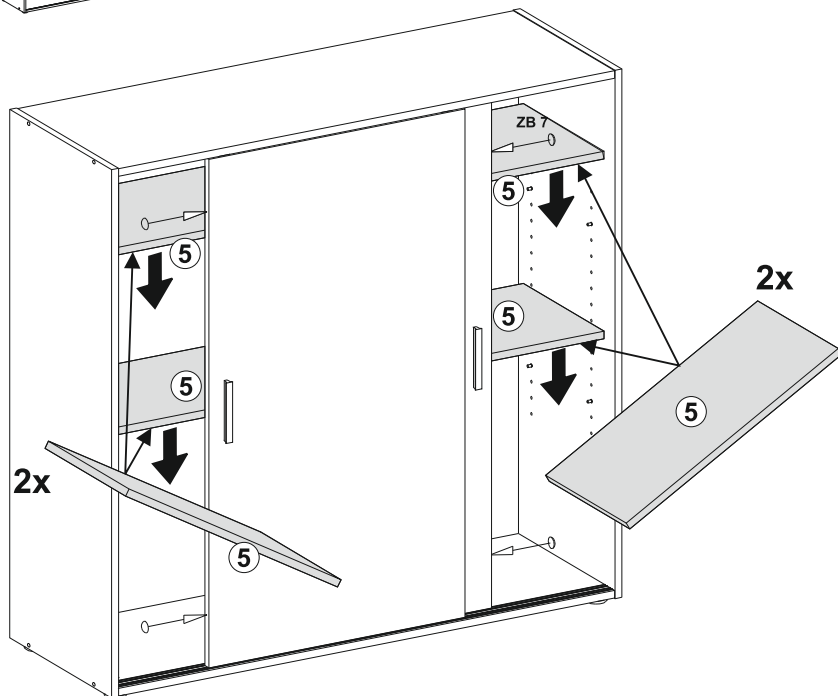
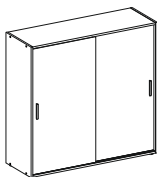

FMD Möbel GmbH
Heidländer Weg 68
D-49201 Dissen a.T.W.
@ service@fmd-moebel.de
 **+49 5421 9448-44**

IAN 345494

