

# SILVERCREST®



## TRUE WIRELESS BLUETOOTH® IN-EAR HEADPHONES STSK E1 A1

(GB) (IE) (NI)

### TRUE WIRELESS BLUETOOTH® IN-EAR HEADPHONES

Quick Start Guide

(NL) (BE)

### TRUE WIRELESS BLUETOOTH® IN-EAR-OORTJES

Quick-Start-Guide

(DE) (AT) (CH)

### TRUE WIRELESS BLUETOOTH® IN-EAR-KOPFHÖRER

Quick-Start-Guide

IAN 409470\_2207

(IE) (NI) (NL)

GB/IE/NI	Quick Start Guide	Page	3
NL/BE	Quick-Start-Guide	Pagina	11
DE/AT/CH	Quick-Start-Guide	Seite	19

## **Quick Start Guide**

This information sheet forms an integral part of the instruction manual. Keep it in a safe place together with the instruction manual. If you hand the product on to third parties, all documentation should be passed on as well. Before using the product, read the instruction manual and pay particular attention to the safety notes in it.

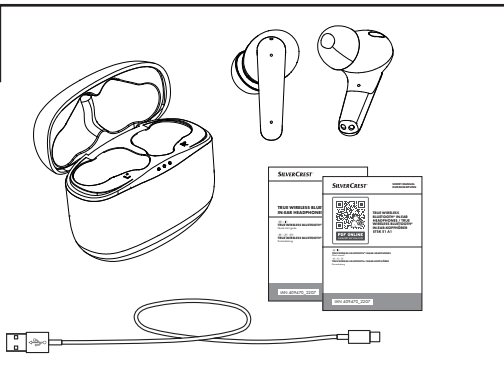
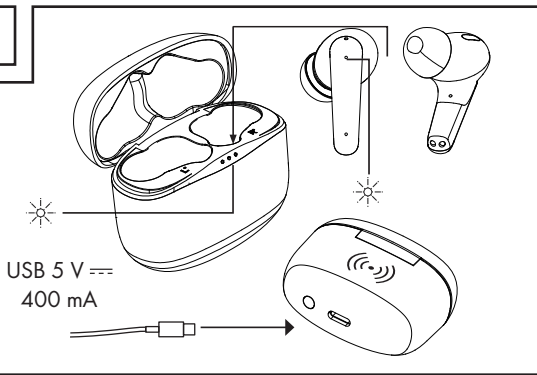
**A****B**

**C**

On

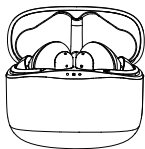

Off

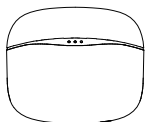
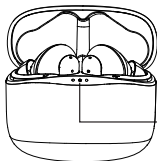
**D**

\* 10s

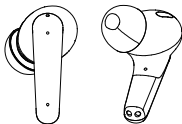
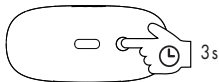
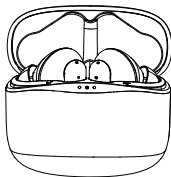
**E****F**

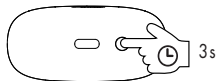
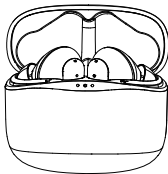
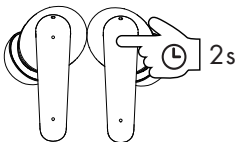
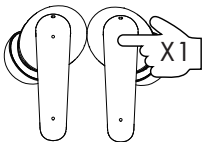
**G****H**

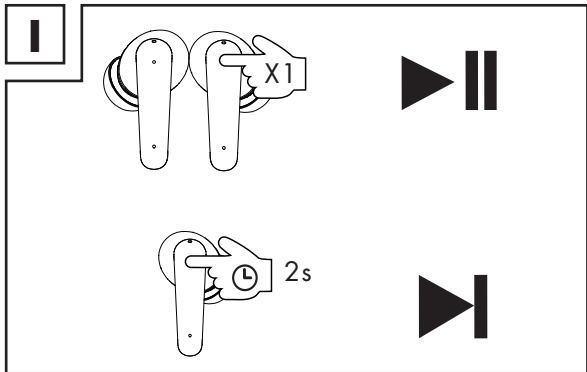







**A**

After unpacking the product, check if the delivery is complete and if all parts are in good condition.

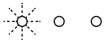
**B**

## ● Charging

① LED	Battery charge status
	< 33 %
	< 66 %
	< 100 %
	100 %

## ● Other functions

C

On, Off

D

Press once on multi-function button on charging case and LED light will light up to display battery capacity for 10 seconds.

E

### ● Pairing the headphones with a Bluetooth device

- On your Bluetooth device, search for the device named **STSK E1 A1** and pair with the device.
  - If your Bluetooth device prompts you to enter a password, enter **0000**.

F

Press and hold for 3 seconds on multi-function button on charging case, this can enable the earphone Bluetooth pairing function. And you can now pairing smartphone to earphone.

G

Press and hold for 3 seconds on multi-function button on charging case, this can disconnect Bluetooth connection of earphone to smartphone.

H

Calling functions

I

Playback function

## **Quick-Start-Guide**

Dit informatieblad is een vast bestanddeel van de gebruiksaanwijzing. Bewaar het goed, samen met gebruiksaanwijzing. Overhandig ook alle documenten als u het product aan derden doorgeeft. Lees voor het gebruik van het product de gebruiksaanwijzing en let met name op de daarin vermelde veiligheidsinstructies.

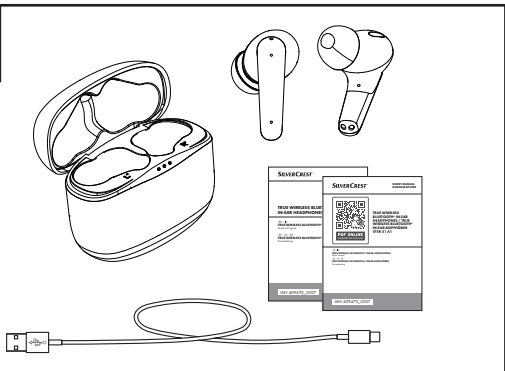
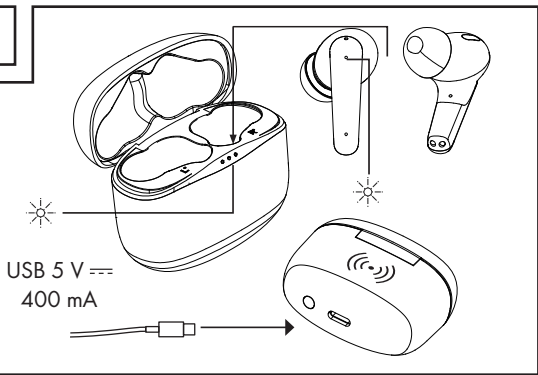
**A****B**

**C**

Aan

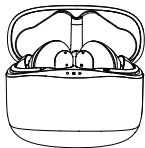

Uit

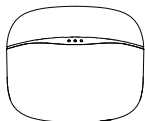
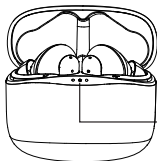
**D**

\* 10s

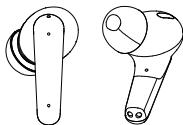
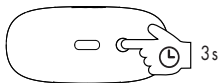
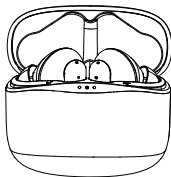
**E****F**

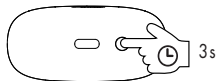
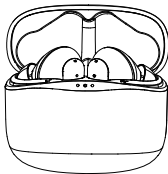
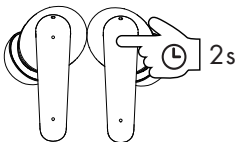
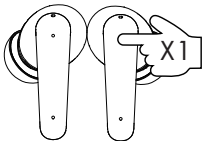
**G****H**

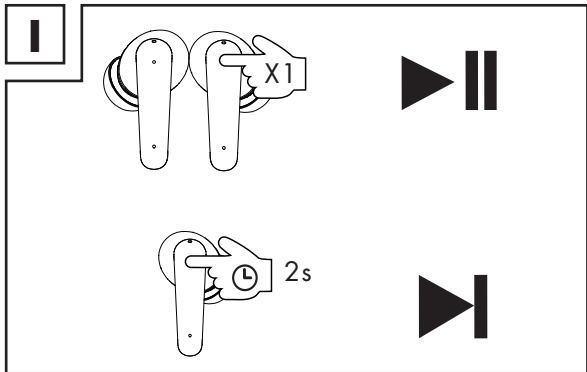



**A**

Controleer na het uitpakken van het product of alles aanwezig is en of alle onderdelen in goede staat zijn.

**B**

## ● Bezig met laden

**① LED****Batterijlaadstatus**

&lt; 33 %



&lt; 66 %



&lt; 100 %



100 %

## ● Overige functies

C

Aan, Uit

---

D

Druk eenmaal op de multifunctionele knop op de laadetui en het LED-lampje gaat branden om de batterijcapaciteit gedurende 10 seconden weer te geven.

---

E

### ● De koptelefoon koppelen met een Bluetooth-apparaat

- Zoek op uw Bluetooth-apparaat naar het apparaat met de naam **STSK E1 A1** en koppel met het apparaat.
    - Als uw Bluetooth-apparaat u vraagt om een wachtwoord in te voeren, voert u **0000** in.
- 

F

Houd de multifunctionele knop op de laadetui 3 seconden ingedrukt. Hierdoor kan de Bluetooth-koppelfunctie van de oortelefoon in worden geschakeld. En u kunt de smartphone en de oortelefoon nu koppelen.

---

G

Houd de multifunctionele knop op de laadetui 3 seconden ingedrukt. Hierdoor kan de Bluetooth-verbinding tussen de oortelefoon en de smartphone worden verbroken.

---

H

Oproepfuncties

---

I

Afspeelfunctie

---

## **Quick-Start-Guide**

Dieses Informationsblatt ist fester Bestandteil der Bedienungsanleitung. Bewahren Sie es zusammen mit der Bedienungsanleitung gut auf. Händigen Sie alle Unterlagen bei Weitergabe des Produkts an Dritte mit aus. Lesen Sie vor der Verwendung des Produkts die Bedienungsanleitung und beachten Sie insbesondere die darin enthaltenen Sicherheitshinweise.“

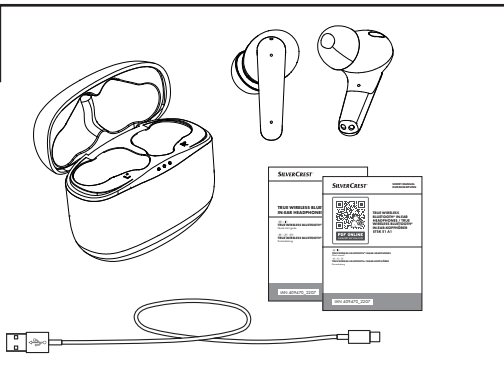
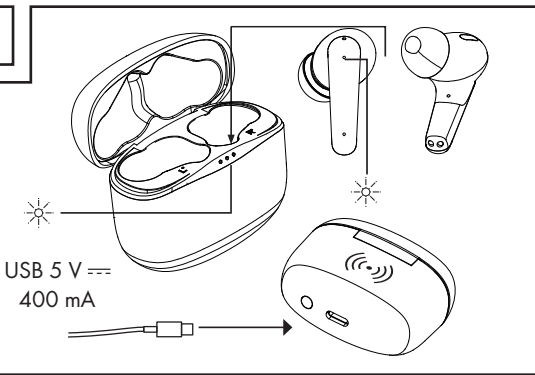
**A****B**

**C**

Einschalten

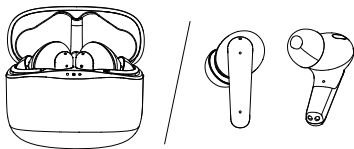

Ausschalten

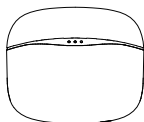
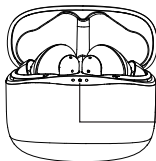
**D**

\* 10s

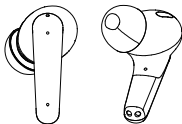
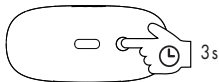
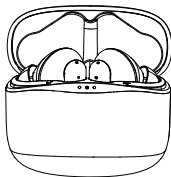
**E****F**

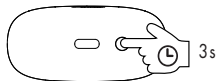
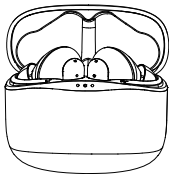
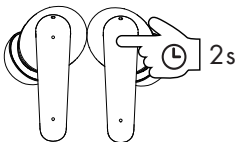
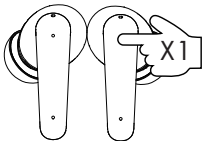
**G****H**

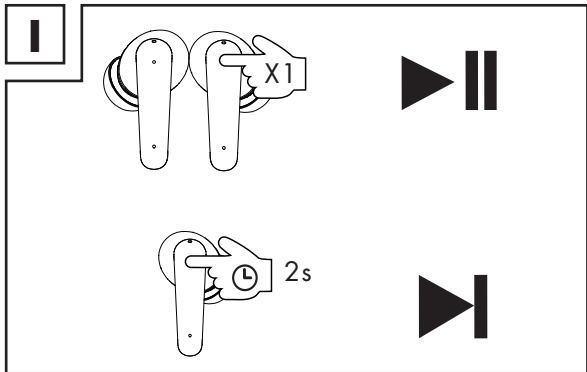



**A**

Überprüfen Sie das Produkt nach dem Auspacken auf Vollständigkeit und einen einwandfreien Zustand aller Teile.

**B**

## ● Aufladen

**① LED****Akku-Ladestatus**

&lt; 33 %



&lt; 66 %



&lt; 100 %



100 %

## ● Andere Funktionen

C

Einschalten, Ausschalten

---

D

Drücken Sie die Multifunktionstaste am Ladegehäuse einmal und die LED leuchtet zur Anzeige der Akkukapazität 10 Sekunden auf.

---

E

### ● Kopfhörer mit Bluetooth-Gerät koppeln

- Suchen Sie auf Ihrem Bluetooth-Gerät nach dem Gerätenamen **STSK E1 A1** und verbinden sich mit diesem.
    - Falls Ihr Bluetooth-Gerät ein Passwort anfragt: Geben Sie **0000** ein.
- 

F

Halten Sie zum Aktivieren der Bluetooth-Kopplung der Ohrhörer die Multifunktionstaste am Ladegehäuse 3 Sekunden gedrückt. Nun können Sie das Smartphone mit dem Ohrhörer koppeln.

---

G

Halten Sie zum Trennen der Bluetooth-Verbindung zwischen Ohrhörer und Smartphone die Multifunktionstaste am Ladegehäuse 3 Sekunden gedrückt.

---

H

Anruffunktionen

---

I

Wiedergabefunktion

---



**OWIM GmbH & Co. KG**

Stiftsbergstraße 1  
74167 Neckarsulm  
GERMANY

Model No.: HG09897A / HG09897B  
Version: 02/2023

IAN 409470\_2207

IE

NI

NL